

# BCU Basic Set Up

**1 BCU WAX SETTING**  
Set Adjustment 1/2 way in

**2 BCU PUMP SETTING**

**3**

**4**

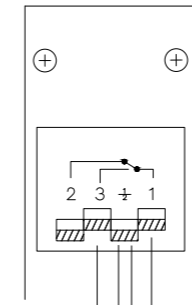
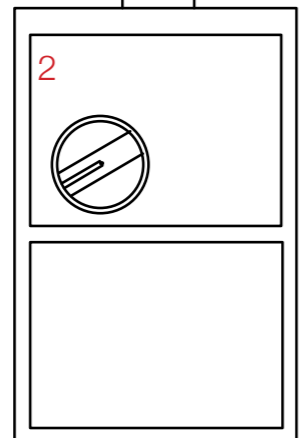
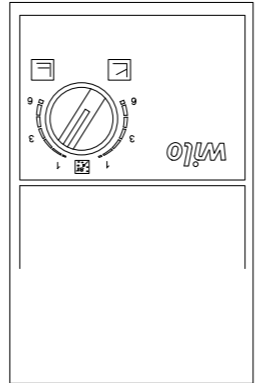
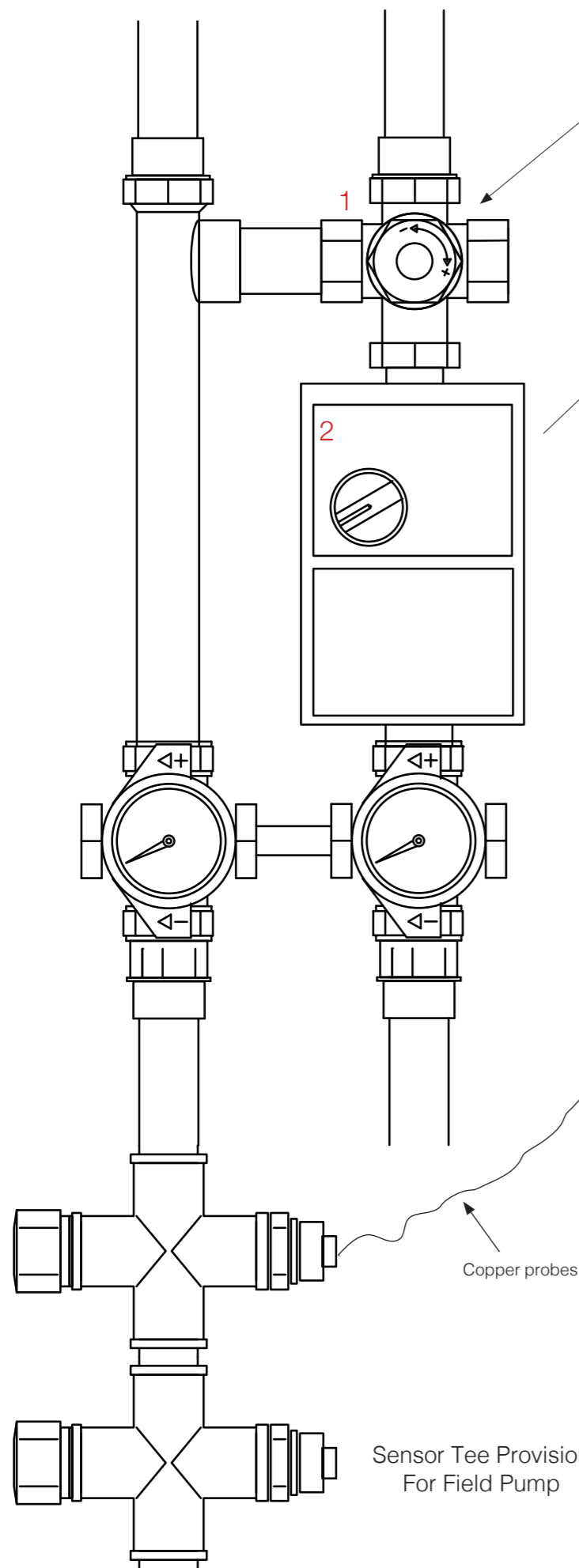

Active Thermostat wired to come on at 20 degrees # See wiring diagram supplied with thermostat

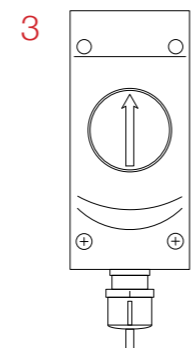
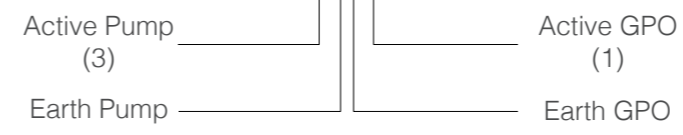

Reducing Caps Supplied by Pivot

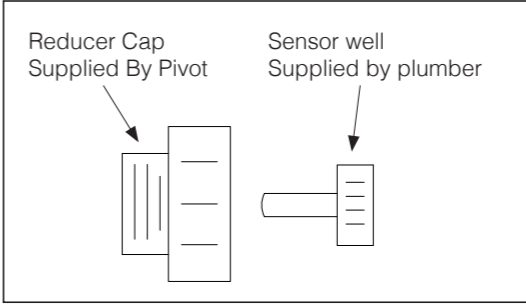

- Notes:
1. Allen key to be dialled all the way in. And one and a half turns outwards, this is the correct mix of cold and hot water.
  2. Pump setting to be set to number 1 towards the left hand side on the constant setting, as indicated.
  3. Siemens thermostat to be wired to turn the pump of one to temperatures reach 55.0. This is wired to terminal 2 & 2.
  4. Sensor Tee's one to be installed below the BCU on the flow line. Two thermostats required for the BCU.

\* It is recommended to operate the BCU with two thermostats, one activating the pump at a lower temperature and to shut off at a higher temperature.  
\* Typical install requires only one thermostat to shut off at a higher temperature.

Pivot Stove and Heating

## Hydronic Manual

Project Number	N/A
Date	24/9/16
Drawn By	Pivot Hydronics
Checked By	Pivot Hydronics

### A- 7.00

REV	-
Sheet Number	7

\*NOT TO SCALE\*