

Insulated Room Seal Flue Kit

2 Story Painted Floor Penetration Kit

2 Story Painted Floor Penetration Kit

	Item	QTY	Product Code
A	1000mm 6" Single skin flue Painted Black Inside diameter: 150mm	2	RFS-6PAINT
B	1000mm starter length, end painted for drop box Inside diameter: 150mm Outside diameter: 200mm	1	RSF-1000 Starter
C	1000mm Room Sealed Flue (with Locking Band) Inside diameter: 150mm Outside diameter: 200mm	1	RSF-1000
O	1000mm RSF, painted black (with Locking Band) Inside diameter: 150mm Outside diameter: 200mm	3	RFS-1000-PAINTED
D	100mm Heat Shield Black	1	RSF-SHIELD
E	RSF Ceiling Ring	1	RSF-CEILINGRING
K	Floor Plate	2	RSF-FLOORPLATE
F	Wind Cowl Stainless Steel Inside diameter: 150mm Outside diameter: 200mm	1	RFS-COWL
G	Room Sealed Flue Adapter Single to twin 150mm - 200mm	1	RSF-STARTER

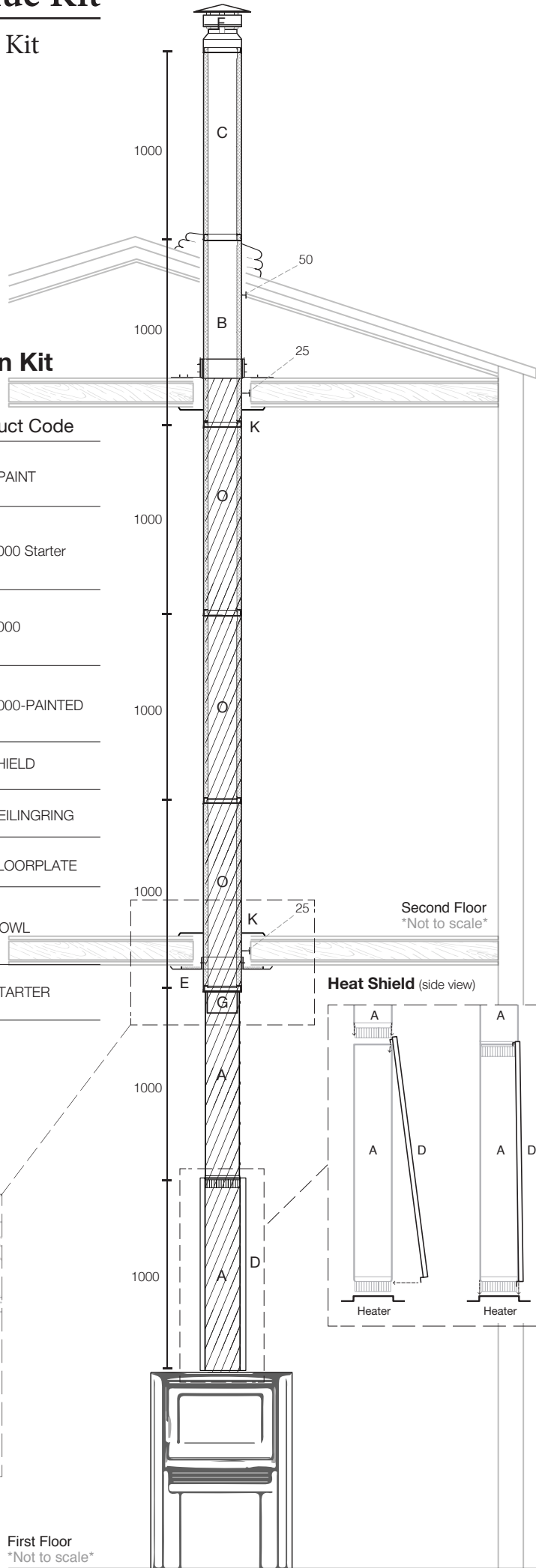

Starter Length

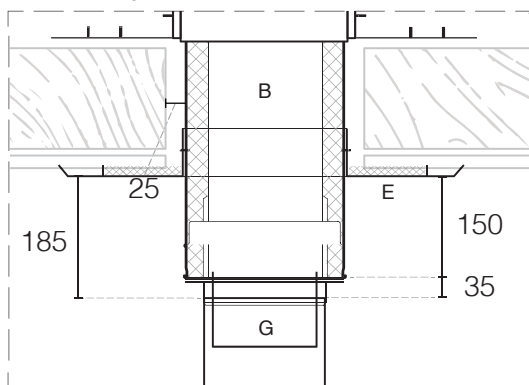

NOTE:
 150mm single skin flue (A) must terminate 185mm from the ceiling. The 200mm starter length (B) dropping 150mm into the room, with the tail dropping into the A flue
 There is a 25mm clearance between the flue and any timber at all times

First Floor
 Not to scale