

est. 1876

PIVOT

stove & heating

Room Sealed

— DIY Flue Kit —

Install Guide

Please check with your local Council / State laws when installing your wood heater to see if this guide is applicable to you.

When installing your wood heater, ensure you follow working at heights regulations and have adequate fall protection, appropriate personal safety equipment including safety goggles, isolating power where required as per your local Council and State health and safety guidelines. There may be further safety requirements not listed in this guide.

Ensure your heater is installed as per the manufacturers specifications with recommended clearances and hearth requirements.

Insulated Room Sealed Flue Kit

Fully Sealed 4m Flue Kit
Painted Insulated RSF from the heater
Stainless Steel RSF outside the home

RSF FK6FULLYINSULATED
 Also available in
 RSF FK5FULLYINSULATED
 RSF FK7FULLYINSULATED
 RSF FK8FULLYINSULATED
 RSF FK9FULLYINSULATED

Optional Support Brace

NOTE:
 The optional support brace (N) has the ability to adjust to any angle of adjacent roof beams
 There is a 25mm clearance between the flue and any timber at all times

Flue Assembly

NOTE:
 To assemble flue, first lock into place, second secure locking band around joint

Fully Sealed Flue Kit

Item	QTY	Product Code
O	2	RSF-1000-PAINTED
B	1	RSF-1000-STARTER
C	1	RSF-1000
E	1	RSF-CR
F	1	RSF-COWL
G	1	RSF-6STARTER

Paint Finish: Stove Bright Metallic Black

Ceiling Ring

NOTE:
 There is a 25mm clearance between the flue and any timber at all times

Pivot Stove's Insulated Room Sealed Flue (RSF) Kit – DIY

The RSF kit is tested and approved to AS/NZS2918:2008 and can be used on all makes and model wood heaters.

The Standard RSF kit when installed is 4 meters in height. All flue and components are required to be used to comply with the AS/NZS2918:2008 wood heater installation standards.

Additional bends, lengths and bracing can be purchased at pivotonline.com.au or at your local Pivot Stove approved hearth store.

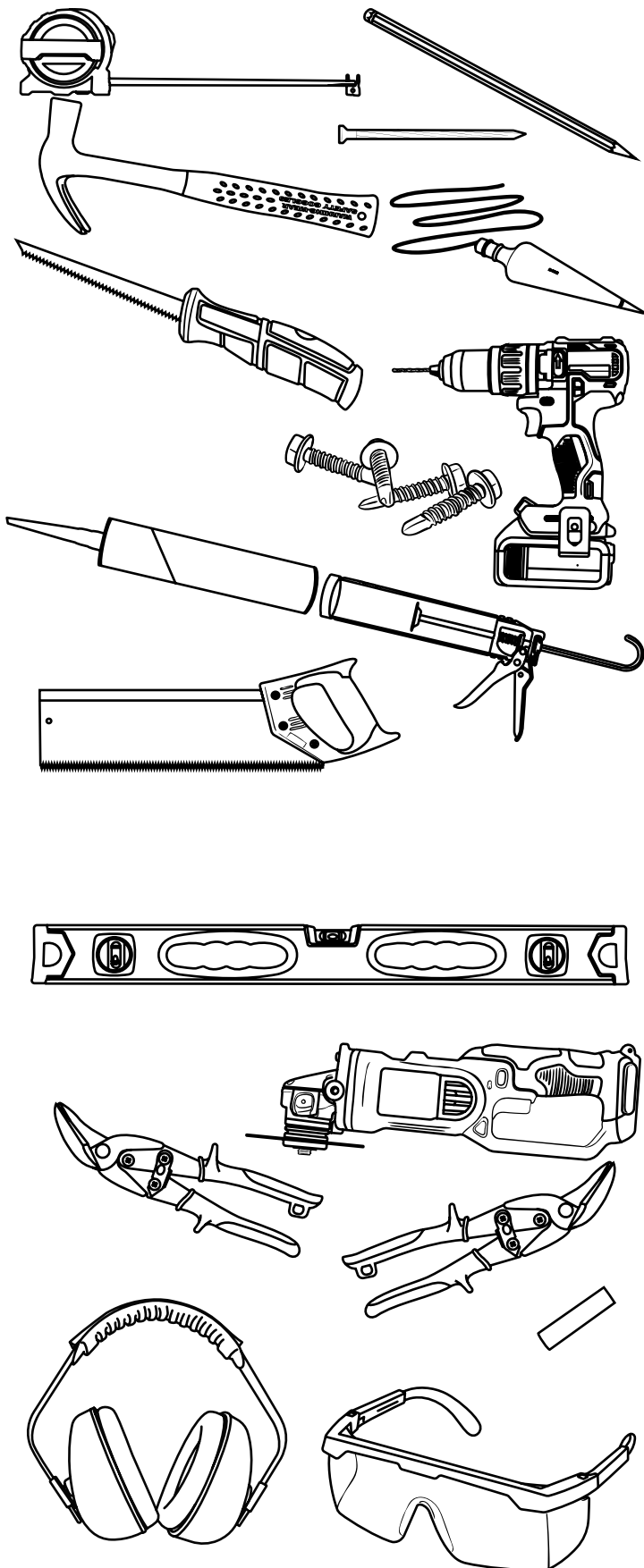

Required Tools

- Tape Measure
- Pencil
- Long Nail / Tek Screw
- Hammer
- Plumb Bob
- Plaster Saw
- Drill
- 25mm Roofing Screws
- Silicone Gun
- Clear Roofing Silicone
- Wood Saw
- Level

IF installing on a **tile** roof:

- Angle grinder with masonry cutting blade
- Chalk

IF installing on a **tin** roof:

- Red handle tin snips
- Green handle tin snips

Safety Equipment

- Hearing Protection
- Safety Goggles

To watch scan the QR codes throughout this guide



TIN ROOF



TILE ROOF

**images not to scale*

Overview on Installing Insulated Room Sealed Flue

When looking for a position for your wood heater, first check there are no obstructions / structural timbers above your heater.

Step 1. Install RSF Starter to heater spigot
Page 5

Step 2. Positioning Heater
Page 6

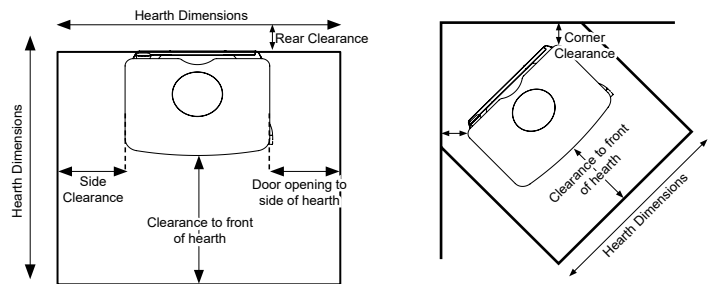

NOTE: Refer to your wood heater Installation manual

Step 3. Finding center of flue on your ceiling
Page 6

Step 4. Scribe and cut your hole in your ceiling
Page 7

Step 5. Cutting hole for center of flue on your roof
Page 8

Step 6. Install ceiling ring
Page 10

Step 7. Installing flue lengths
Page 10

Step 8. (Optional) Installing ceiling brace
Page 10

Step 9. Cut roof (tiles or tin)
(Optional) Install flashing
Page 11

Step 10. Connect cowl and last length
Page 13

Step 11. Safety checks and clearances
Page 13

Watch a full install:



Full installation

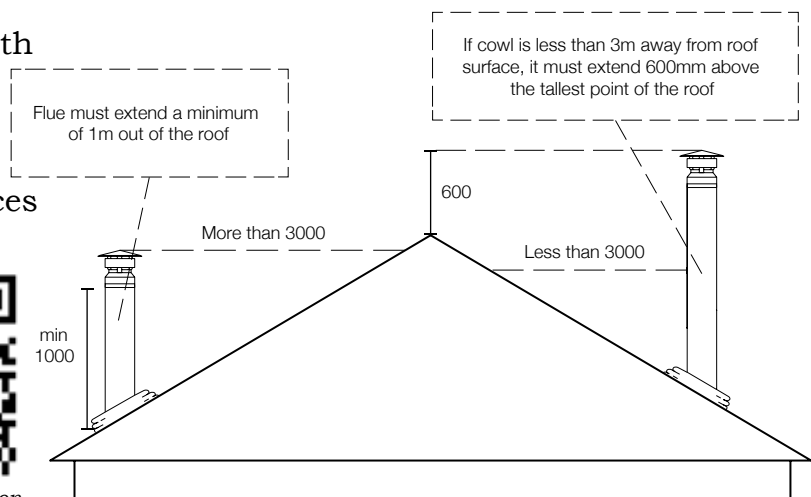

How to join Insulated Room Sealed Flue



Remove the locking band from the fitting

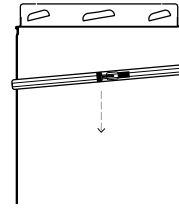

How to connect flue

Twist the flue (or fitting) clockwise to join flue

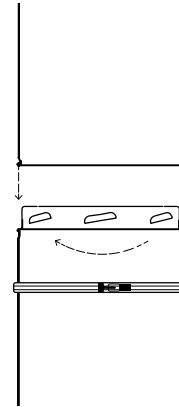

To secure the join, attach the locking band and latch at the back

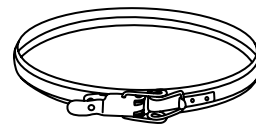
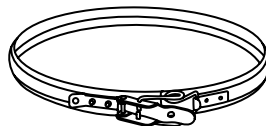
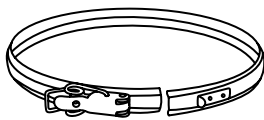
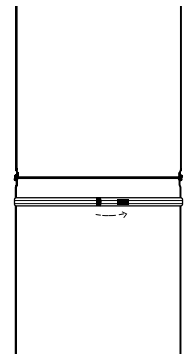

Step 1: Check your heater for secure flue connection

NOTE: The RSF Starter needs to be a firm fit INSIDE your wood heaters spigot. If the fitting is loose, wrap a single layer of heat resistant tape (included) around the RSF Starter



Step 1

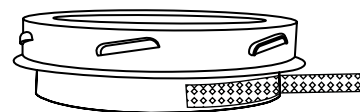
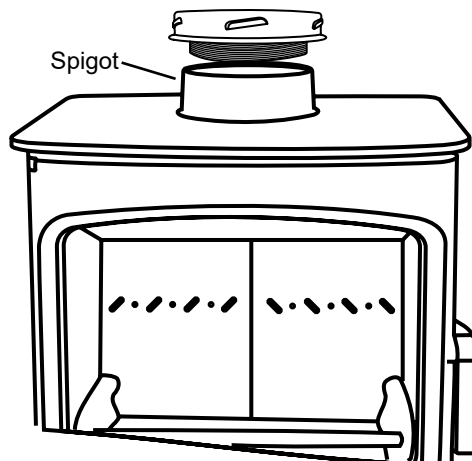

Installing Insulated Room Sealed Flue

Step 2

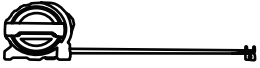

Position your wood heater as per the manufacturers instructions. Check and confirm clearances as per your wood heater's manual.



Step 2

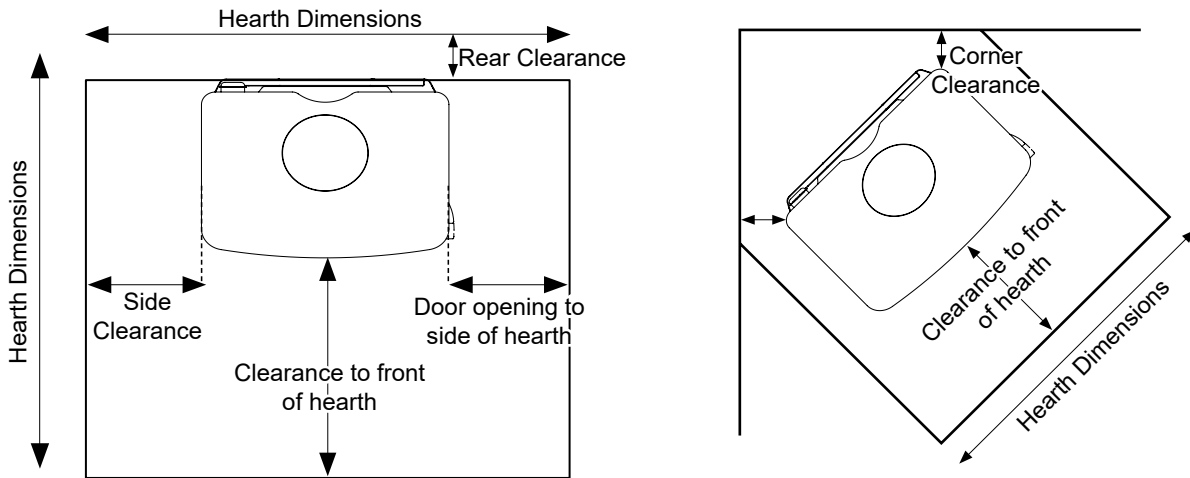

NOTE: Refer to your wood heater Installation manual

Check to make sure there are no obstructions / restrictions in the flue path (so it can go straight through)

Watch for structural beams, electrical wires, ducted heating, hips, ridges, valleys, solar panels and other things that cannot be moved / relocated.

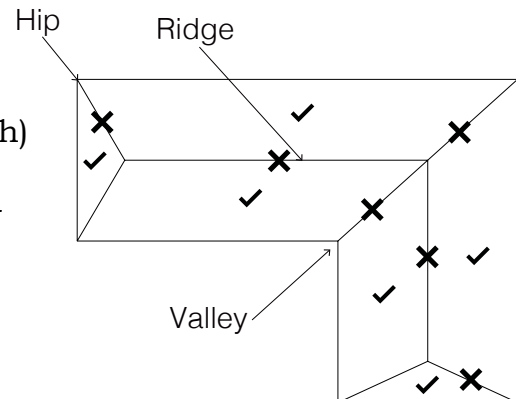

Step 3



Using a plumb bob or a weighted string line, find the center of the flue position and mark it on the ceiling.



Step 3

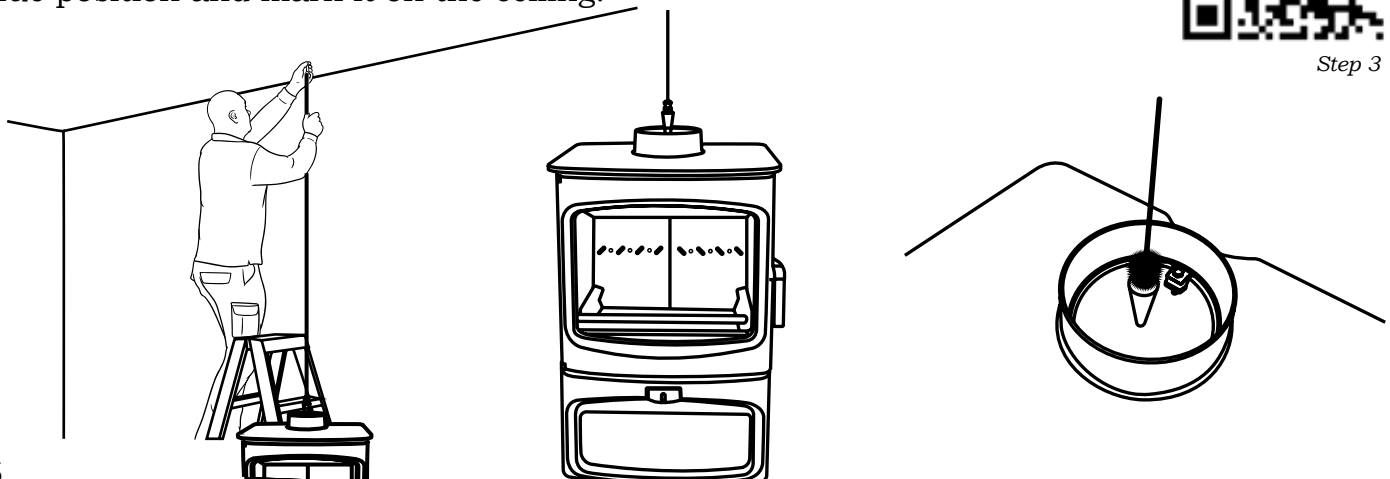

Installing Insulated Room Sealed Flue



Using a long nail, push through the ceiling where you have marked the center point for the flue.

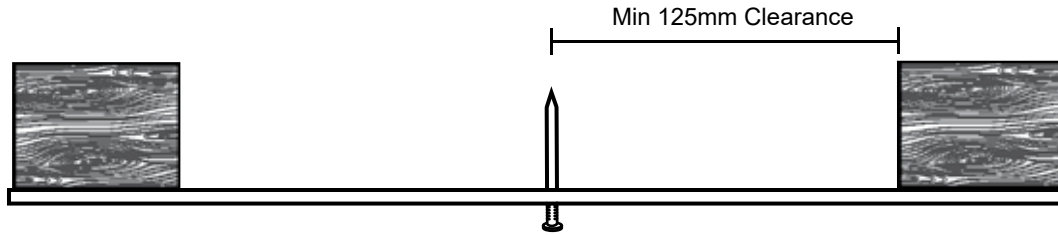

In the ceiling cavity, locate the nail and check to ensure you have 125mm clearance from all major timbers.

*NOTE: Do not cut or remove any structural beams.
Plaster battens may be cut.*

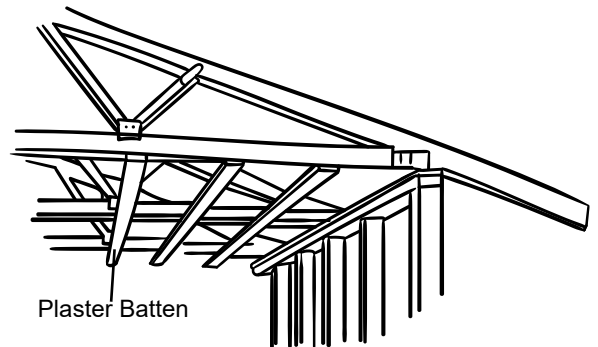

Step 4



Using a scribe set at 125mm, scribe your ceiling
(This will give you the 250mm sized hole you require)



Step 4

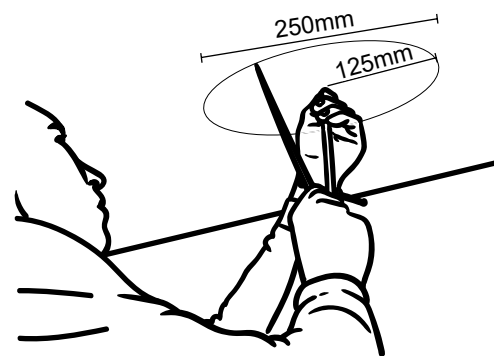
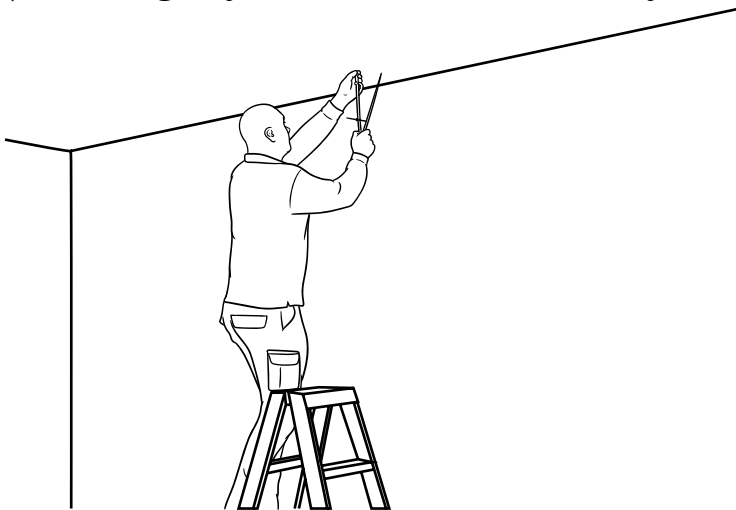

Using a plaster saw, cut the hole where you have scribed.



Installing Insulated Room Sealed Flue

This section refers to TILED Roof ONLY

See below for Metal Roof



Remove any roof tiles (from above the hole you have just cut)

Cut out any tile battens exposed

NOTE: 25mm clearance to any combustibles

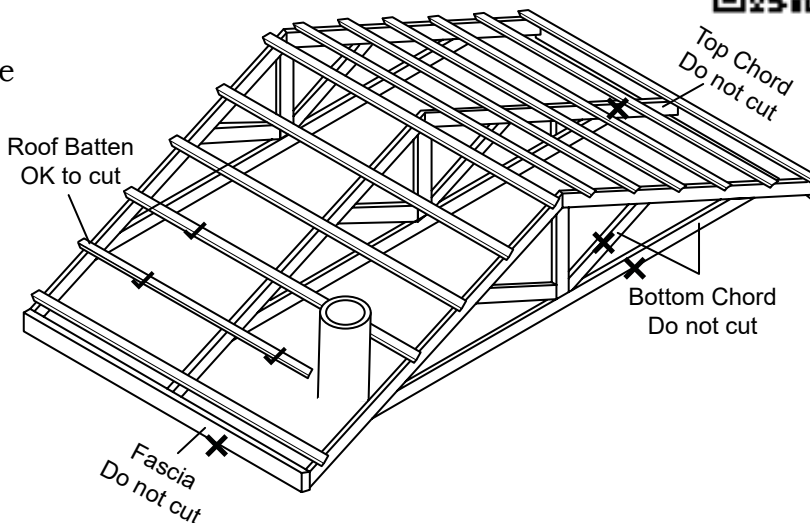

This section refers to METAL Roof ONLY

See above for Tiled Roof



Using the plumb bob again, locate the center of the weighted end of the plumb bob to the center of the wood heaters flue spigot.

Find and mark the position on the underside of the tin roof

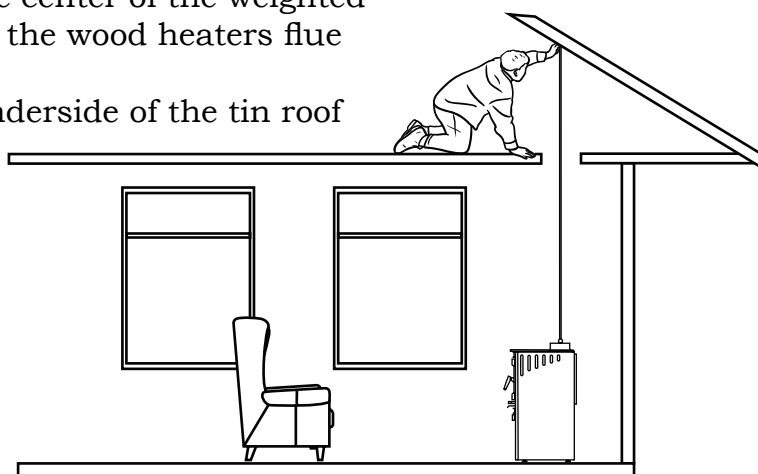

Using a long tek screw as a locator, drill up into your roof to locate the flue penetration

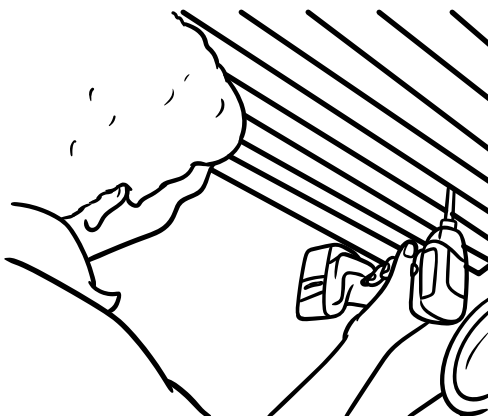

Installing Insulated Room Sealed Flue

This section refers to METAL Roof ONLY

See previous for Tiled Roof



Using a scribe set at 105mm, scribe your roof.
(This will give you the 210mm sized hole you require)

*NOTE: Your roof pitch may alter hole shape
(the sharper the pitch, the more oval this will
end up)*

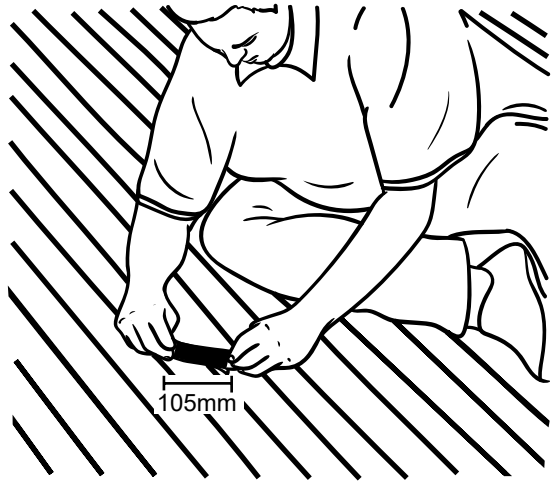

To start your hole use an angle grinder to cut, or use red and green tin snips.
Cut the hole where you have scribed.

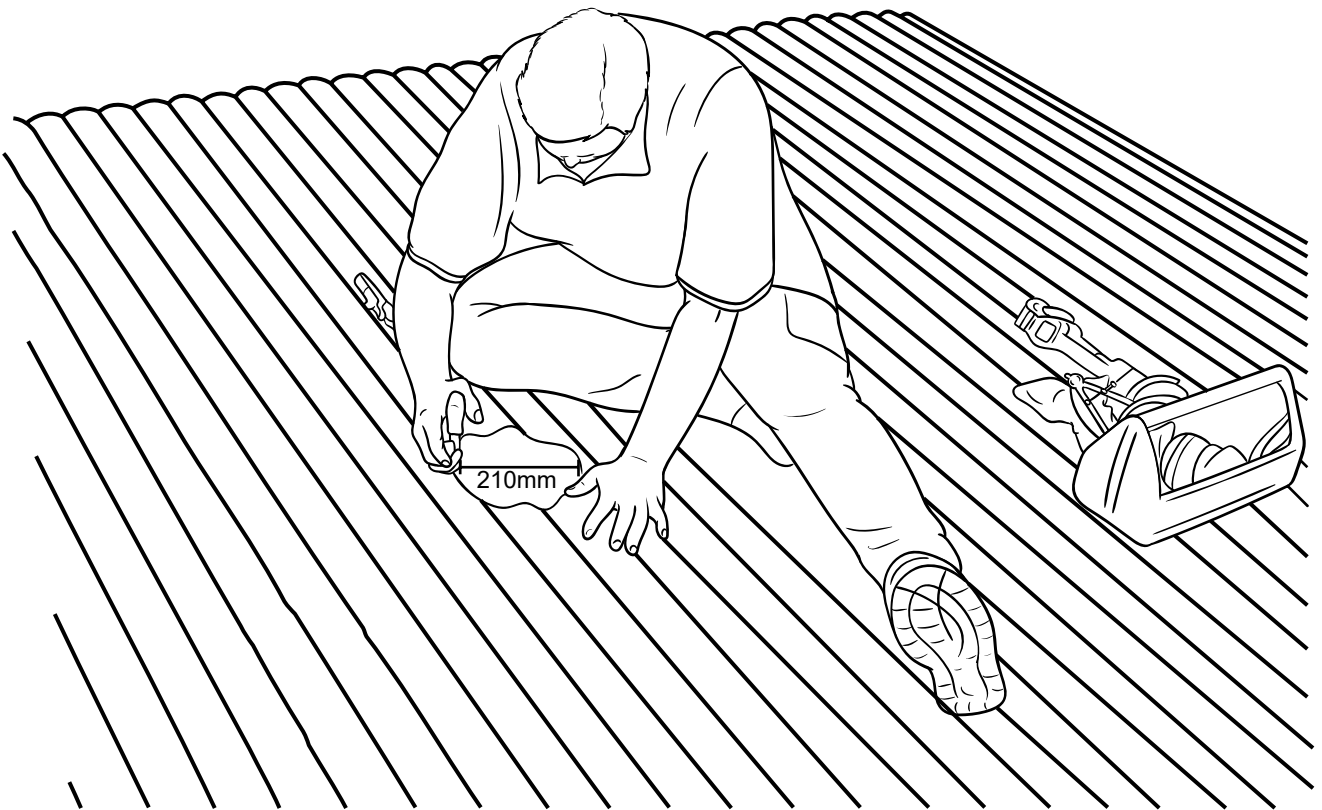

*NOTE: If you do use an angle grinder, ensure you clean off ALL shavings from your roof
to prevent any rust damage.*

Installing Insulated Room Sealed Flue



Install ceiling ring. Bend the three tabs on the ceiling ring and use a wood screw to secure these three tabs to the closest timber in the ceiling cavity

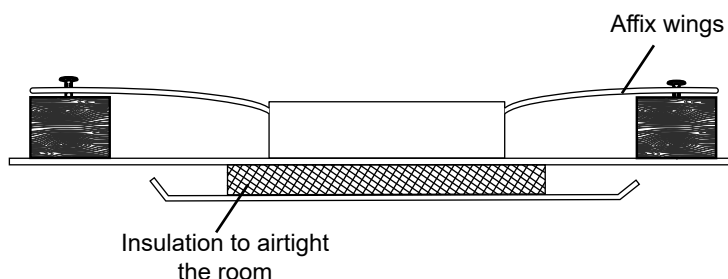

Step 6

NOTE: Make sure the insulation in the ceiling ring is pushed up hard to the ceiling and center to the hole

Step 7

a. Connect the RSF Starter (G) to RSF 1000-Painted (O)
Replace in the Flue Spigot on your Wood Heater

b. Join the second length of RSF 1000-Painted (O)

c. Join RSF 1000-Starter (B)

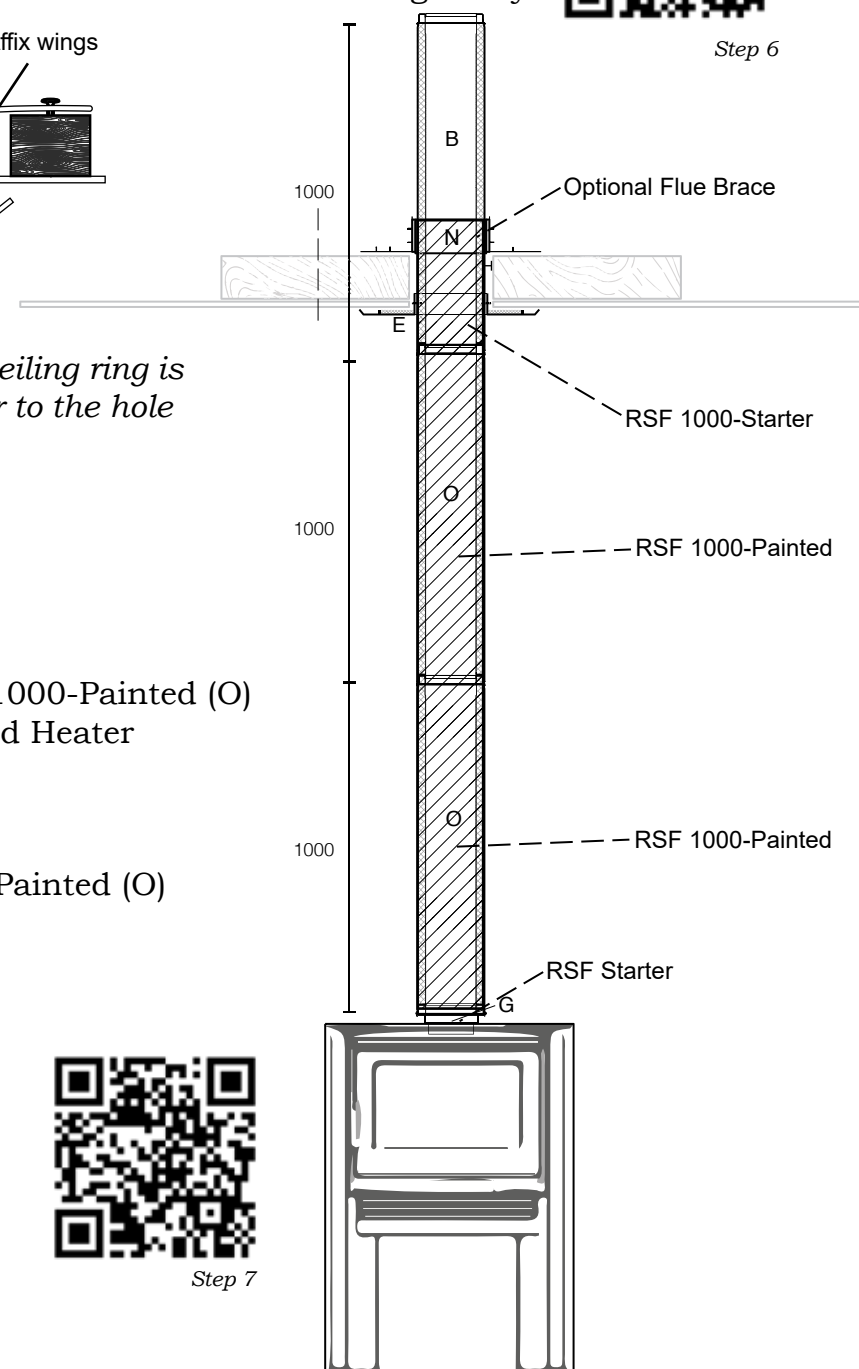

Step 7

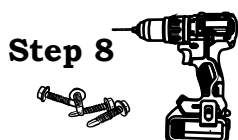

OPTIONAL

If bracing flue in the ceiling cavity with the optional RSF Brace
Secure this to flue and timber beam

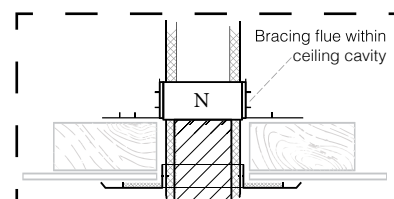

NOTE: Before securing, place level on top of flue both front to back and side to side to ensure the flue is straight.



Step 8

Installing Insulated Room Sealed Flue



This section refers to **TILED Roof ONLY**

See over for *Metal Roof*



Position roofing tiles around the flue
You need to cut roofing tiles to fit around your flue.
Mark the tile with chalk

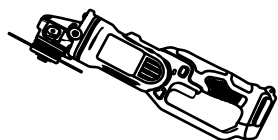
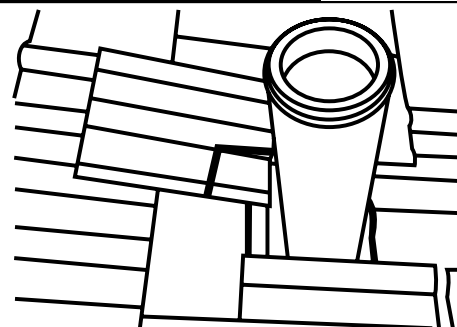

SAFETY NOTE: *Never cut tiles on roof, ensure you do this on the ground with all recommended safety equipment.*

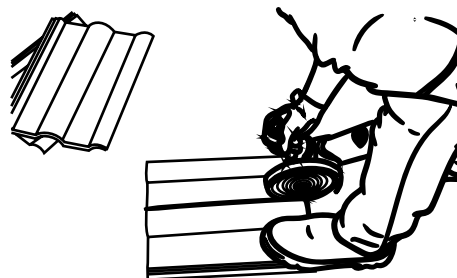

Using an angle grinder with a masonry or diamond cutting disk, cut marked tiles.

Once tiles are cut, position back on your roof

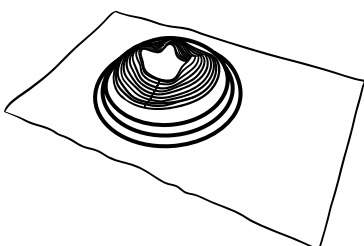
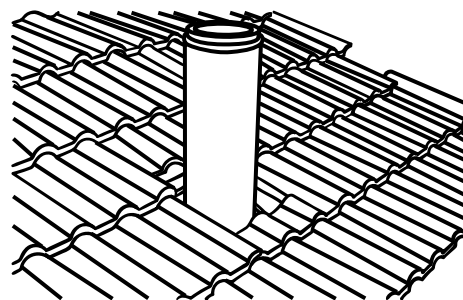

Using a No7 Aqualead flashing
**Not included in flue kit*

On the leading edge (high end) fold over 20mm to make a **water break**

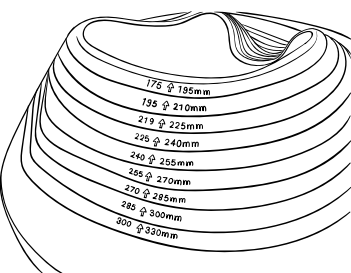
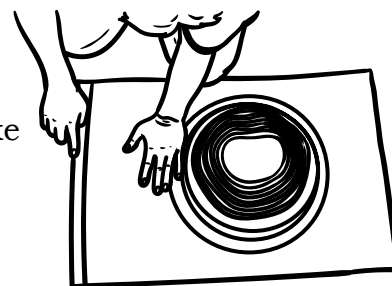

Cut flashing to suit 200mm flue

To install, place the leading edge with the **water break** under the tiles on the high side of the roof

Form flashing on lower part of roof to the tiles

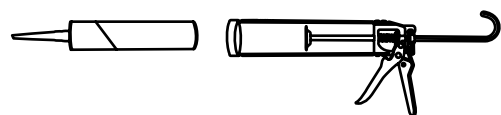
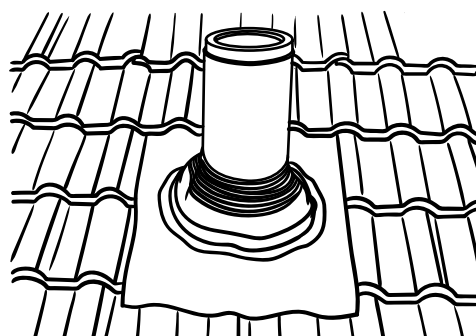

Using roof silicone, run the sealant around the top of the flashing ensuring it is watertight.

Installing Insulated Room Sealed Flue

This section refers to METAL Roof ONLY
See previous for Tiled Roof



Step 9

To Flash

- Use No7 Flashing for Low pitch roof
 - Use No8 Flashing for High pitch roof
- *Not included in flue kit*

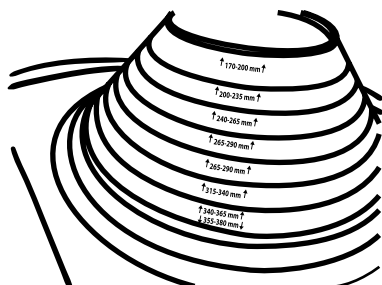
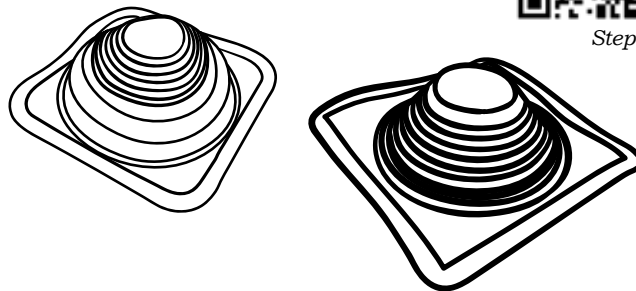

Cut flashing to suit 200mm flue

Slip Flashing over flue and shape to your roof

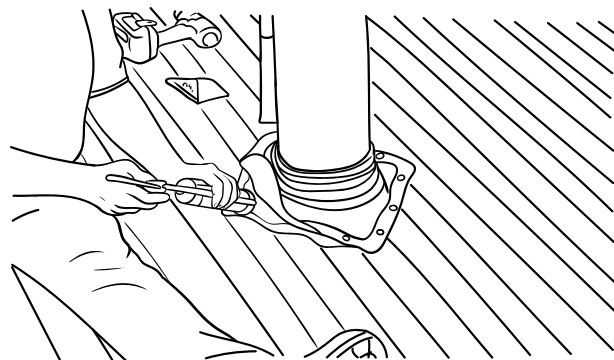
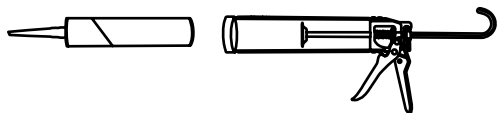

Run a bead of silicone on the underside.
Push firmly onto your roof

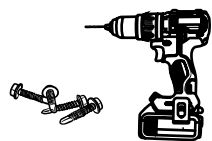

Using roofing screws (ensure these are self drilling metal screws with sealing washer)
Secure your flashing to your roof on every ridge

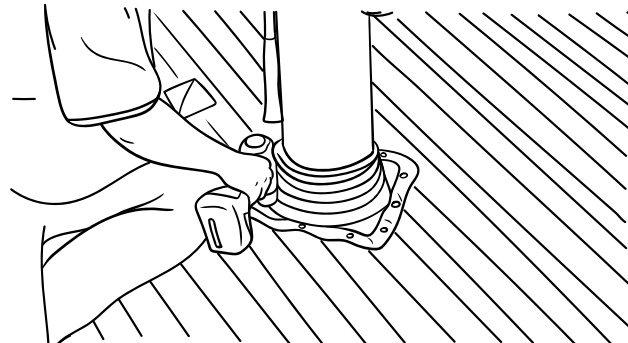

NOTE: Use 25mm roofing screws for metal

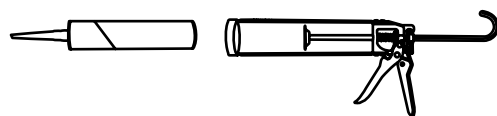

Using roof silicone, run the sealant around the top of the flashing ensuring it is watertight.

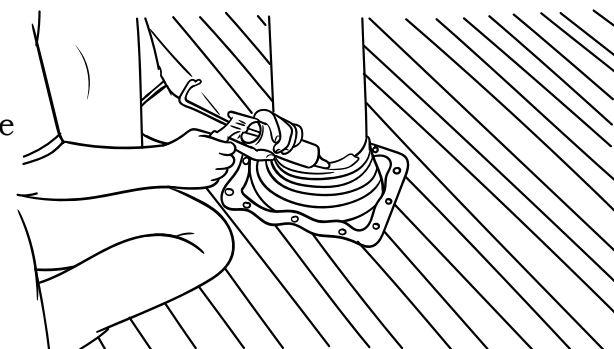

Installing Insulated Room Sealed Flue

Step 10

Before you put the last length of flue on, twist and lock RSF Cowl to RSF 1000

Secure the cowl with the locking band.

Connect last length to installed flue.



Step 10

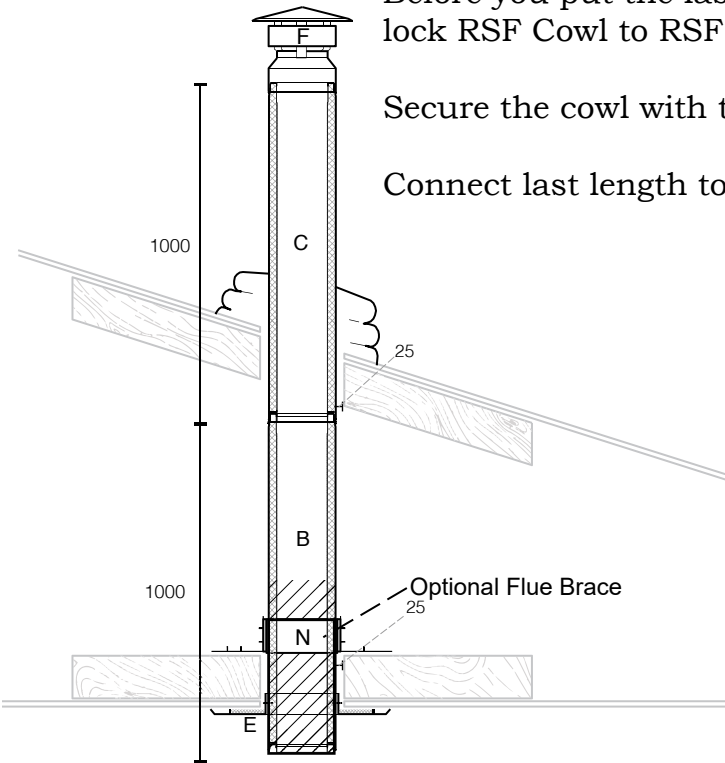

SAFETY CHECKS







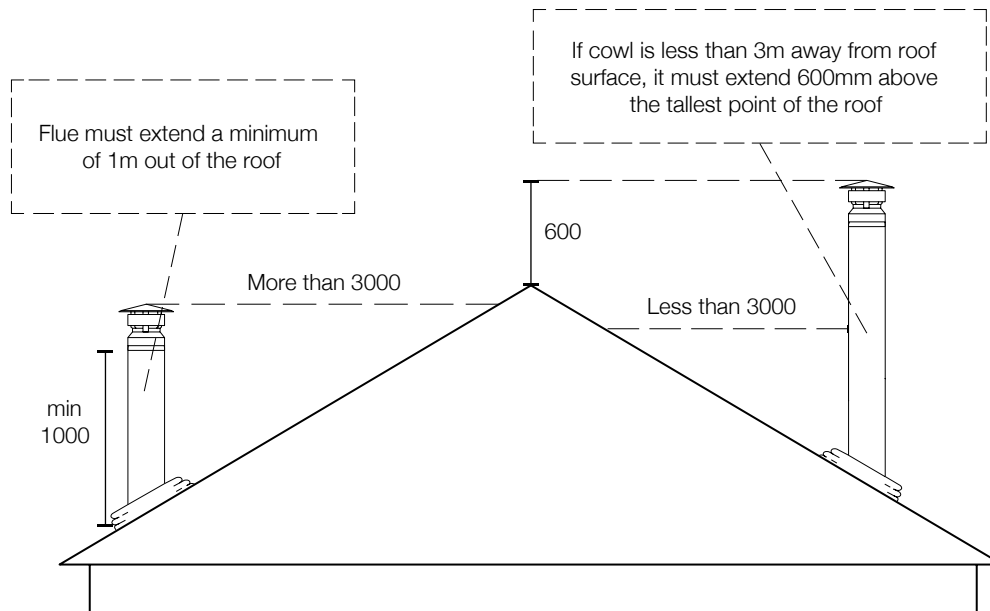
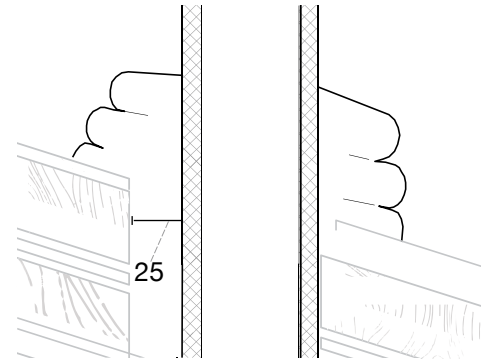



To ensure your new flue is correctly installed



- Flue is 25mm away from any timbers
- Nothing is touching your flue
- Flue height is correct



Insulated Room Sealed Flue Parts

Individual Item Description		Part Number
6" / 150mm Flue		
6" RSF 1,000mm Straight Pipe <i>including locking band</i>		RSF-1000
6" RSF 1,000mm Straight Pipe, Fully Painted <i>including locking band</i>		RSF-1000-PAINTED
6" RSF 100mm Straight Pipe <i>including locking band</i>		RSF-100
6" RSF 100mm Straight Pipe, Fully Painted <i>including locking band</i>		RSF-100-PAINTED
6" RSF 500mm Straight Pipe <i>including locking band</i>		RSF-500
6" RSF 500mm Straight Pipe, Fully Painted <i>including locking band</i>		RSF-500-PAINTED
6" RSF 340mm-500mm Adjustable Pipe <i>including locking band</i>		RSF-ADJUST
6" RSF 340mm-500mm Adjustable Pipe Painted <i>including locking band</i>		RSF-ADJUST-PAINTED
6" RSF 90° Tee with Cap <i>including locking band</i>		RSF-TEE
6" RSF 45° Bend <i>including locking band</i>		RSF-45oBEND
6" RSF 45° Bend, Painted <i>including locking band</i>		RSF-45oBEND-PAINTED

Optional Flashing

No7
For flat or low pitched tin roof

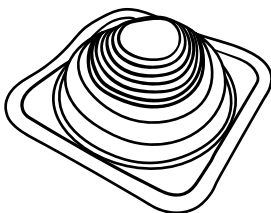

No8
For high pitched tin roof

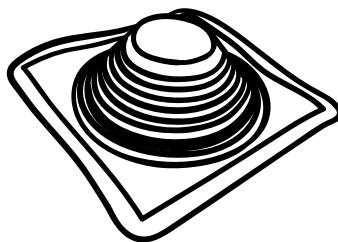

Aqualead
For Tiled Roof

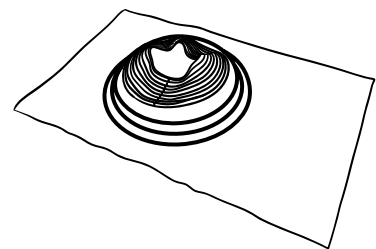

Additional bends, lengths and bracing can be purchased at pivotonline.com.au or at your local Pivot Stove approved hearth store.

Optional Room Sealed Flue Bracing

Support Brace
RSF SUPPORT
Support within ceiling cavity

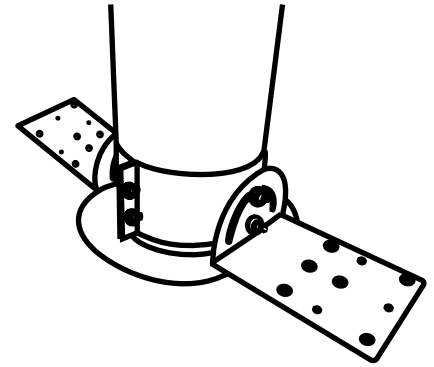
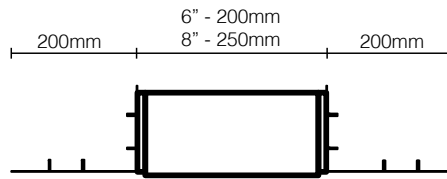

Roof Brace
RSF ROOFBRACE
Support on roof with arms

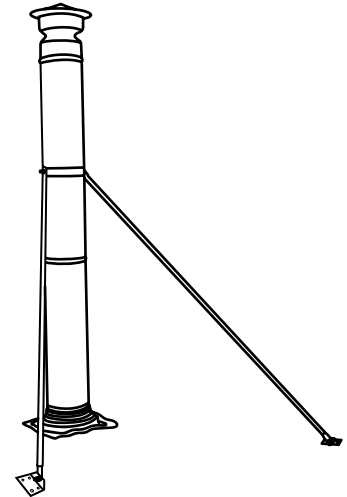
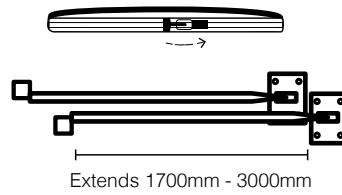

<u>Individual Item Description</u>	<u>Part Number</u>
6" Support Brace	RSF-SUPPORT
6" Roof Bracing Kit <i>with arms</i>	RSF-ROOFBRACE

Stuck? Got Questions?
 Check out our FAQ



pivotstove.com.au



7 Year Limited Warranty on Flue
1 Year Limited Warranty on Cowl
Please see full Terms & Conditions