

# Insulated Room Sealed Flue Kit

## 5m Flue Kit for Cast Iron Fireplaces

### Flue Assembly

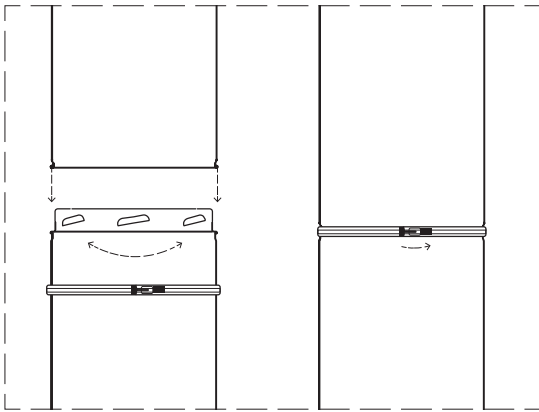

To assemble flue, first lock into place, second secure locking band around joint

### Optional Support Brace

RSF-CS

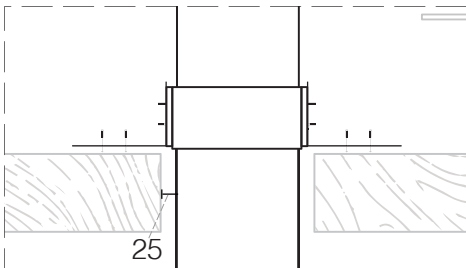

The optional support brace has the ability to adjust to any angle of adjacent roof beams  
\*There is a 25mm clearance between the flue and any timber at all times\*

### Starter Length

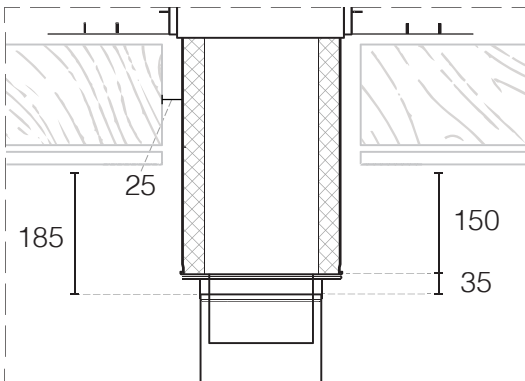

single skin flue must terminate 185mm from the ceiling. The starter length dropping 150mm into the room, with the tail dropping into the flue  
\*There is a 25mm clearance between the flue and any timber at all times\*

